

SUPPORT UNIT

SUPPORT UNIT FOR BALL SCREW (GREASE-INJECTION TYPE)

Structure

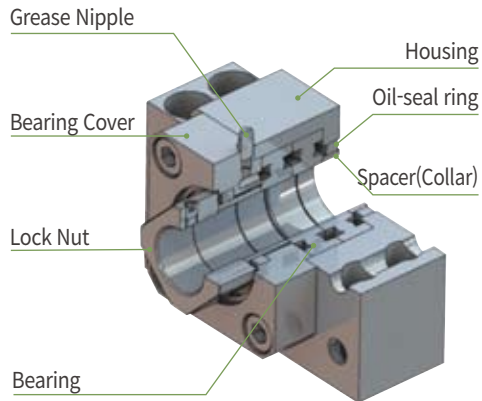

- Advance design with a nipple being attached and a passage carved on the bearing cover for a easier grease refill
- Prevention of foreign material and leak of grease by the inner oil-seal rings
- Accompanied by a high accuracy lock-nut and collars(spacer)

Features of BK-G, FK-G & SWBK-G Series

Easy and Simple Grease Injection : This structure does not require the mounted Support unit to be detached from the ball screw and grease can be simply injected through the nipple on the body.

Enhanced Lubrication Performance & Reduced Bearing Friction : In terms that it is possible to frequently refill grease, it helps to reduce friction/abrasion of bearing and eventually extends the lifespan.

When a Support unit is mounted at a volatile circumstance or used with vertical drive motors, grease usually gets disappeared and lubrication of bearing doesn't run smoothly. Thus, this Grease injection-type Support Unit series lets you refill grease easily and solves this issue.

How To Inject(Refill) Grease

- While a Support Unit is mounted, you may inject grease through the nipple on the Support unit body, rotating the ball screw slowly.

Inject grease through the nipple

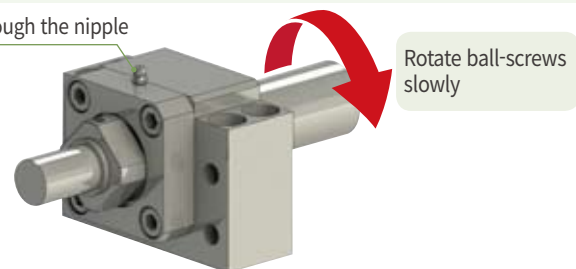

Rotate ball-screws slowly

How to Order

①Precision grade mark	Mark	Bearing precision grade	Preload	②Surface Treatment	mark	Surface Treatment
	P5	P5	Medium		no mark	Black Oxide
C8	General	Medium	RA	Low temperature Black Chrome Plating (Raydent)		
P0-C7	General	Light				

BK17-G

P0-C7

-

Model

Precision grade mark

Surface Treatment

SUPPORT UNIT

SUPPORT UNIT FOR BALL SCREW (GREASE-INJECTION TYPE)

Recommended Shape Of Ball Screw Shaft-End (Fixed Side)

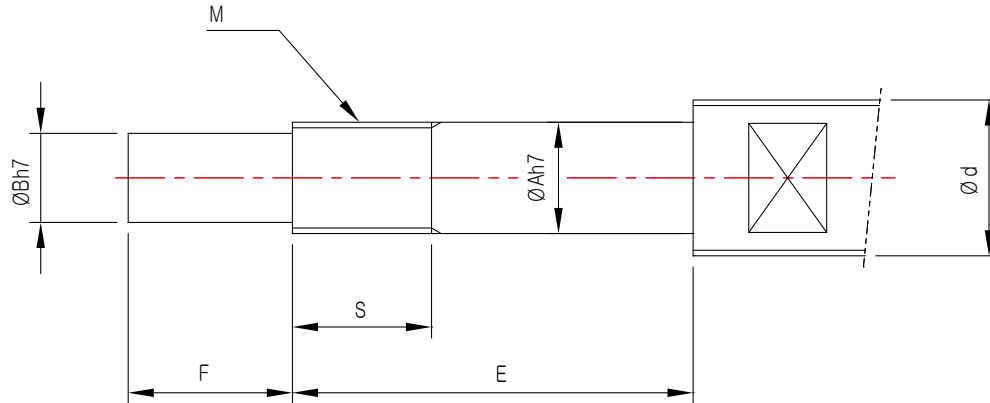

Dimensions(mm)											Lock-nut	
d	A	B	BK				FK				Model	Size (MxPitch)
			Model	E	F	S	Model	E	F	S		
Ø25 - Ø28	17	15	BK17-G	65	23	17	FK17-G	67	23	17	RN17	M17 x 1
	20	17	BK20-G	65	25	17	FK20-G	73	25	17	RN20	M20 x 1
Ø30 - Ø36	25	20	BK25-G	80	30	20	FK25-G	86	30	20	RN25	M25 x 1.5
Ø40	30	25	BK30-G	87	38	25	FK30-G	87	38	25	RN30	M30 x 1.5
Ø45	35	30	BK35-G	93	45	28	FK35-G	93	45	28	RN35	M35 x 1.5
Ø50 - Ø55	40	35	BK40-G	114	50	35	FK40-G	114	50	35	RN40	M40 x 1.5

Dimensions(mm)								Lock-nut	
d	A	B	SWBK				Model	Size (MxPitch)	
			Model	E	F	S			
Ø25 - Ø28	17	15	SWBK17-G	DF	93	23	22	HLRN17	M17 x 1
				DFD	108				
Ø30 - Ø36	25	20	SWBK25-G	DF	93	25	24	HLRN20	M20 x 1
				DFD	108				
Ø40	30	25	SWBK30-G	DF	98	30	25	HLRN25	M25 x 1.5
				DFD	113				
Ø45	35	30	SWBK35-G	DF	98	38	25	HLRN30	M30 x 1.5
				DFD	113				
Ø50 - Ø55	40	35	SWBK40-G	DF	101	45	27	HLRN35	M35 x 1.5
				DFD	116				
				DFF	131				
Ø50 - Ø55	40	35	SWBK40-G	DF	106	50	32	HLRN40	M40 x 1.5
				DFD	121				
				DFF	136				

SUPPORT UNIT : BK-G SERIES

SUPPORT UNIT FOR BALL SCREW (GREASE-INJECTION TYPE / GENERAL LOAD)

BK17-G ~ BK40-G

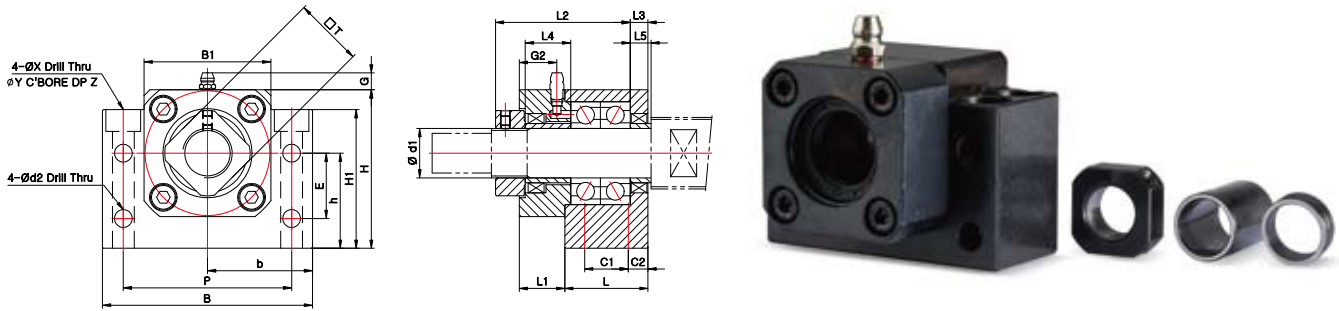

Dimensions

Model	Sizes (mm)																								Mass (g)
	Body																				Spacer(collar)				
	d1	L	L1	L2	L3	B	H	b±0.02	h±0.02	B1	H1	E	P	C1	C2	d2	X	Y	Z	□T	G	G2		L4	
BK17-G	17	35	18	56	7	86	64	43	39	50	55	28	68	19	8	6.6	9	14	8.5	24	8.5	14	19	7	1500
BK20-G	20	35	20	55	8	88	60	44	34	52	50	22	70	19	8	6.6	9	14	8.5	30	8.5	16	20	8	1400
BK25-G	25	42	23	68	9	106	80	53	48	64	70	33	85	22	10	9	11	17.5	11	35	8.5	19	23	9	2600
BK30-G	30	45	21.5	74.5	9	128	89	64	51	76	78	33	102	23	11	11	14	20	13	40	8.5	17.5	22.5	9	3600
BK35-G	35	50	21	77	12	140	96	70	52	88	79	35	114	26	12	11	14	20	13	50	8.5	17	22	12	4800
BK40-G	40	61	27	92.5	15	160	110	80	60	100	90	37	130	33	14	14	18	26	17.5	50	8.5	23	31.5	15	7400

SUPPORT UNIT : FK-G SERIES

SUPPORT UNIT FOR BALL SCREW (GREASE-INJECTION TYPE / GENERAL LOAD)

FK17-G ~ FK30-G

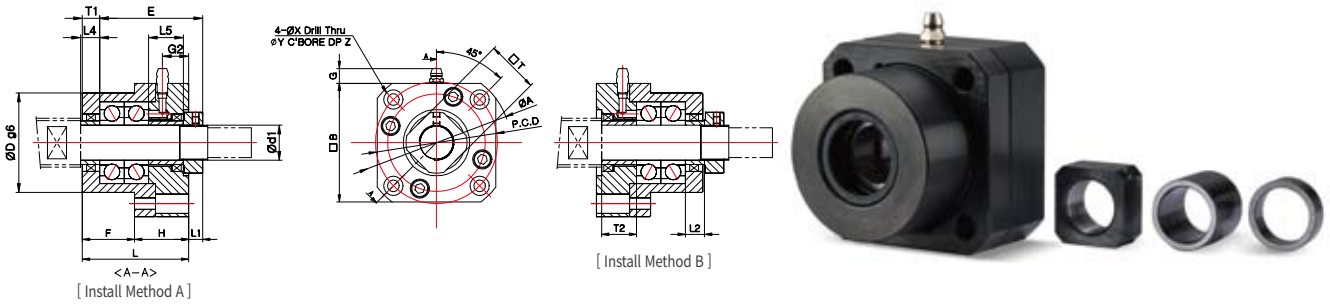

※ **Additional note for [FK-30]**

In case of choosing "Install Method B", size of spacer(collar) needs to be accordingly changed. Please contact Sung-il Customer Service team for more details.

Dimensions

Model	Sizes (mm)																				Mass (g)	
	Body																Spacer(collar)					
	d1	L	H	F	E	D	A	P.C.D	□B	Install Method A L1 T1	Install Method B L2 T2	X	Y	Z	□T	G	G2	L4		L5		
FK17-G	17	55	32	23	56	50	77	62	61	10	9	13	12	6.6	11	20	24	8.5	16	9	19	1100
FK20-G	20	61	31	30	59	57	85	70	68	8	10	12	14	6.6	11	19	30	8.5	15	11	20	1400
FK25-G	25	65	35	30	68	63	98	80	79	13	10	20	17	9	15	21	35	8.5	17	15	23	1800
FK30-G	30	69.5	37.5	32	74.5	75	117	95	93	17	12	17	18	11	17.5	22.5	40	8.5	18.5	9	22.5	2700

FK35-G ~ FK40-G

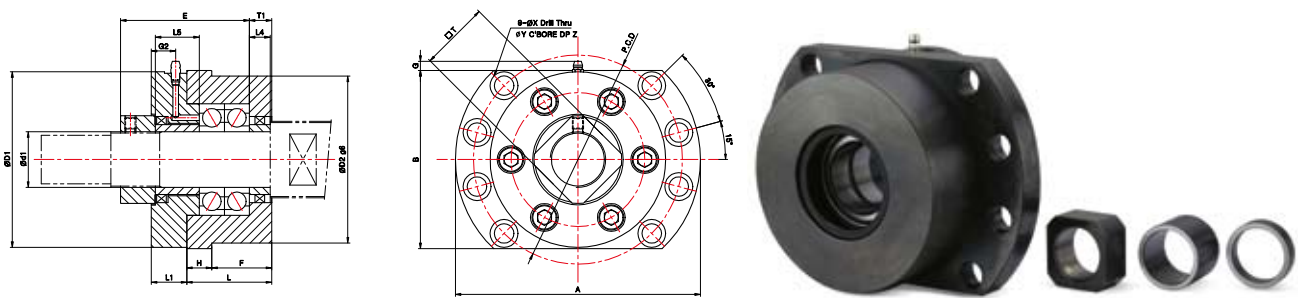

Dimensions

Model	Sizes (mm)																				Mass (g)
	Body																Spacer(collar)				
	d1	L	H	F	E	D1	D2	A	P.C.D	B	L1	T1	X	Y	Z	□T	G	G2		L4	
FK35-G	35	48	16	32	77	112	100	154	132	120	24	12	11	17.5	11	50	3.5	16	12	22	4700
FK40-G	40	61	18	43	92.5	126	120	176	150	128	25.5	16	14	20	13	50	6.5	17.5	15	31.5	7300

SUPPORT UNIT : SWBK-G SERIES

SUPPORT UNIT FOR BALL SCREW (GREASE-INJECTION TYPE / HIGH LOAD)

SWBK17-G ~ SWBK40-G

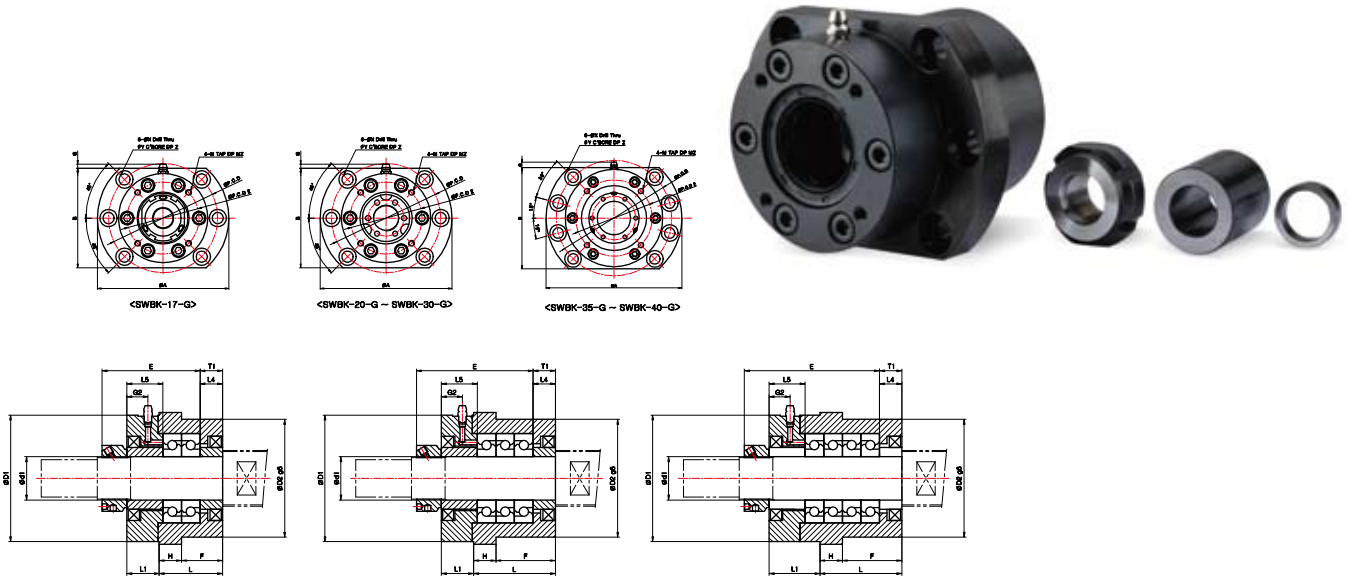

Dimensions

Model	Sizes (mm)																						Mass (g)
	Body																			Spacer(collar)			
	d1	L	H	F	E	T1	D1	D2	A	P.C.D	P.C.D 2	B	L1	X	Y	Z	M	MZ	G	G2	L4	L5	
SWBK17-G-DF	17	47	15	32	76	15	72	70	106	88	58	80	26	9	14	8.5	M5	10	3.5	17	15	28	2300
SWBK17-G-DFD	17	62	15	47	91	15	72	70	106	88	58	80	26	9	14	8.5	M5	10	3.5	17	15	28	2700
SWBK20-G-DF	20	47	15	32	76	15	72	70	106	88	58	80	26	9	14	8.5	M5	10	3.5	17	15	28	2300
SWBK20-G-DFD	20	62	15	47	91	15	72	70	106	88	58	80	26	9	14	8.5	M5	10	3.5	17	15	28	2700
SWBK25-G-DF	25	51	18	33	78	18	90	85	130	110	70	100	25	11	17.5	11	M6	12	2.5	16	18	28	3700
SWBK25-G-DFD	25	66	18	48	93	18	90	85	130	110	70	100	25	11	17.5	11	M6	12	2.5	16	18	28	4300
SWBK30-G-DF	30	51	18	33	78	18	90	85	130	110	70	100	25	11	17.5	11	M6	12	2.5	16	18	28	3600
SWBK30-G-DFD	30	66	18	48	93	18	90	85	130	110	70	100	25	11	17.5	11	M6	12	2.5	16	18	28	4100
SWBK35-G-DF	35	51	18	33	79	18	102	95	142	121	80	106	26	11	17.5	11	M6	12	5.5	17	18	29	4300
SWBK35-G-DFD	35	66	18	48	94	18	102	95	142	121	80	106	26	11	17.5	11	M6	12	5.5	17	18	29	5000
SWBK35-G-DFD	35	66	18	48	109	18	102	95	142	121	80	106	41	11	17.5	11	M6	12	5.5	17	18	29	5800
SWBK40-G-DF	40	51	18	33	81	18	102	95	142	121	80	106	26	11	17.5	11	M6	12	5.5	17	18	29	5000
SWBK40-G-DFD	40	66	18	48	96	18	102	95	142	121	80	106	26	11	17.5	11	M6	12	5.5	17	18	29	6000
SWBK40-G-DFD	40	66	18	48	111	18	102	95	142	121	80	106	41	11	17.5	11	M6	12	5.5	17	18	29	7200